

US18650G7, Cell Safety Requirement

- **Max Charge Voltage; 4.25V/cell** (Open Circuit Voltage)
- Cell Temperature;
Charge ; 0 to 60 deg. C
Discharge; -20 to 70 deg. C
- Charging Current ; less than 0.7C
If capacity is 2400mAh, 0.7C means;
 $2.4A \times 0.7 = 1.68A$
- Discharging Current; less than 1.0C
If capacity is 2400mAh, 1C means;
 $2.4A \times 1 = 2.4A$

US18650G7, Electrical Info.

* Standard Charge Condition

Charge Method : constant current constant voltage
 Charge Up Voltage : 4.2± 0.05V
 Charge Current : 1.0A
 Charge Time : 5.0 hours charge
 Ambiance Temperature : 23°C

at room temperature, 3.0V cut off

Nominal Capacity (0.2C discharge)	2400mAh 9.0Wh	average capacity 3.75V (average discharge voltage)
Rated Capacity (0.2C discharge)	2250mAh 8.4Wh	minimum capacity
Capacity at 0.5C	2350mAh (8.6Wh)	average capacity
Capacity at 1C	2300mAh (8.2Wh)	average capacity
Nominal Voltage	3.7V	
Internal Impedance	55mΩ	measured by AC1kHz
Cycle Performance	80 % of Initial capacity at 300 cycles	0.7A discharge

US18650G7, Mechanical Info.

Cell Size (with plastic tube)

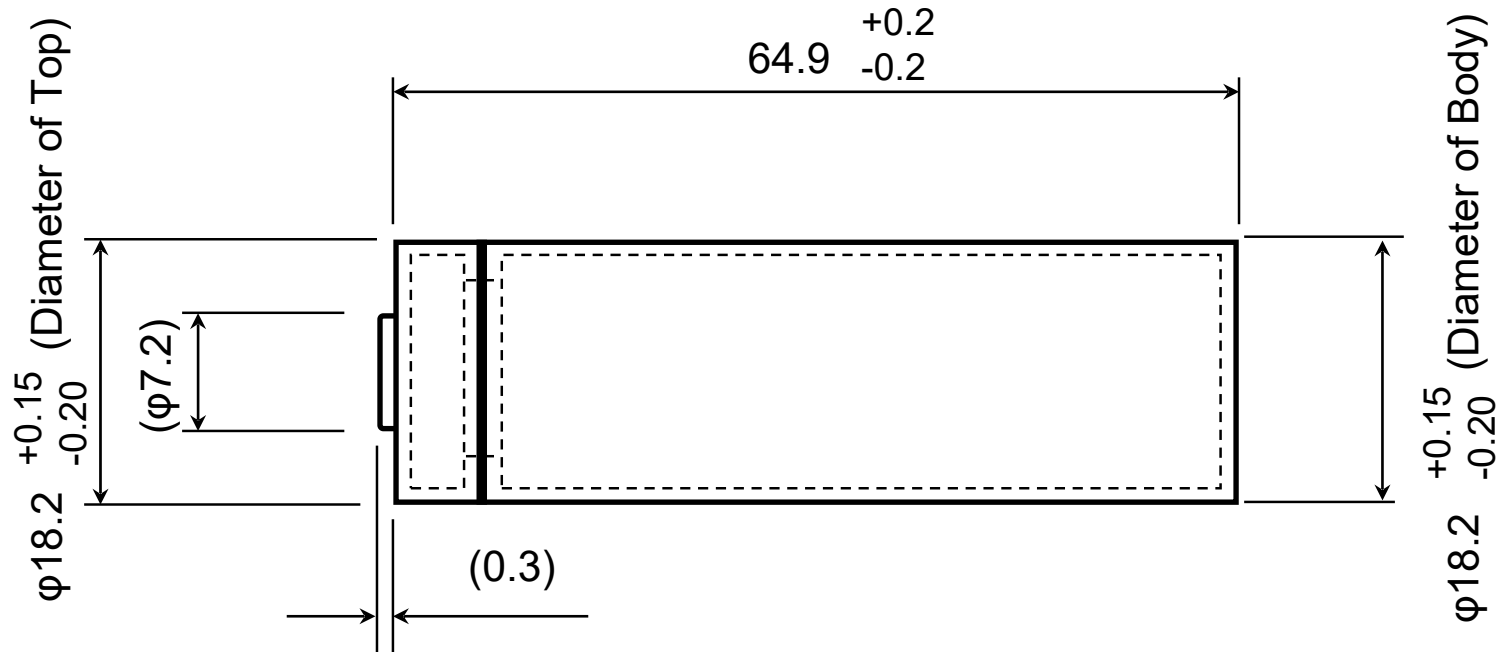

Appendix-1; Discharge Curves of US18650G6

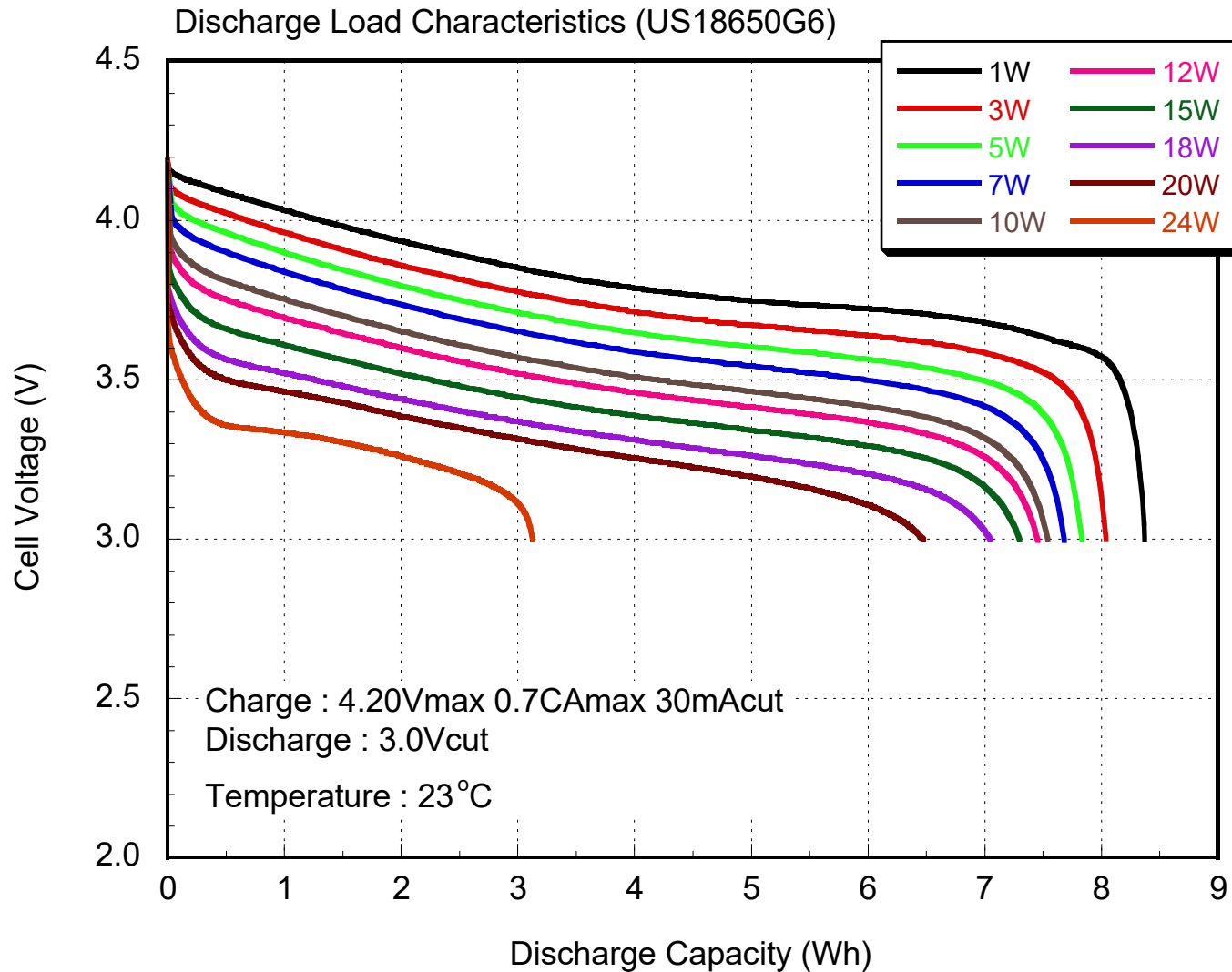

Appendix-2; Charge Curves of US18650G6

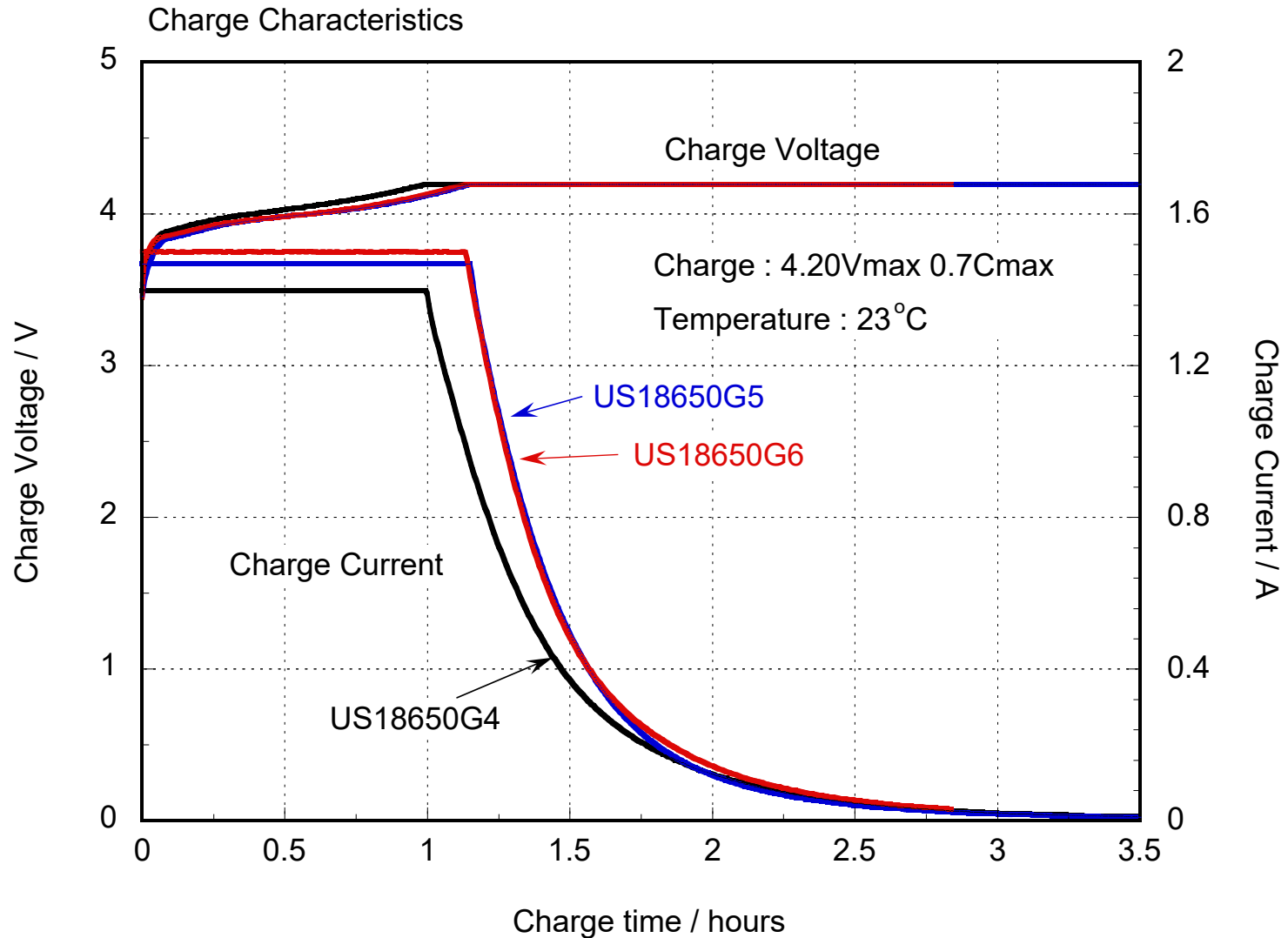

Cell Line Up for PC Battery

CELL		CY2003	CY2004	CY2005
Cylindrical Cell Nominal Capacity	US18650G5	2150mAh/8.1Wh		
	US18650G6			
	US18650G7	2400mAh/9.1Wh		